

Welcome to Diamond Light Source



Parking – Users should park around the synchrotron building. There is limited, short-stay parking in front of Diamond House for users reporting to the User Office.

Users – Should pick up their access cards from Main Gate Reception and go directly to the beamline via one of the entrance zones - see map on reverse.

During your visit – If you experience any problems, please report to the User Office between the hours of 8:30am and 5:00pm Monday to Friday. Outside of these hours, the Experimental Hall Co-ordinators (EHCs) can be contacted on ext 8787.

 No access for visitors and users

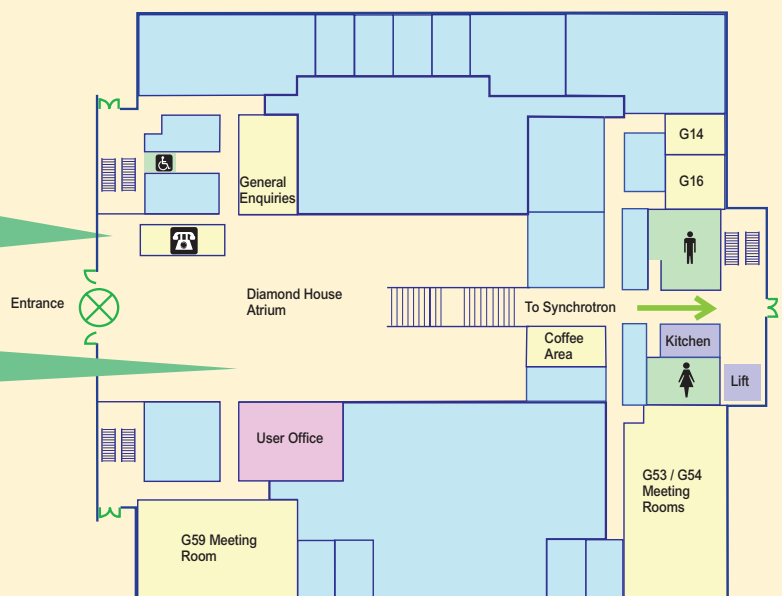

Finding your way around the synchrotron building

